

Käyttö- ja huolto-ohjeet Operating and
maintenance **Manual de uso y mantenimiento**
Gebrauchs- und Wartungsanweisung Manual de
uso e manutenção **Instructions d'utilisation et**
d'entretien **Bruksanvisning och service manual**
Bedienings- en onderhoudsvorschriften
Инструкции по эксплуатации и техническому
об обслуживанию v 2.0







1

2

3

4

5

6

7

8

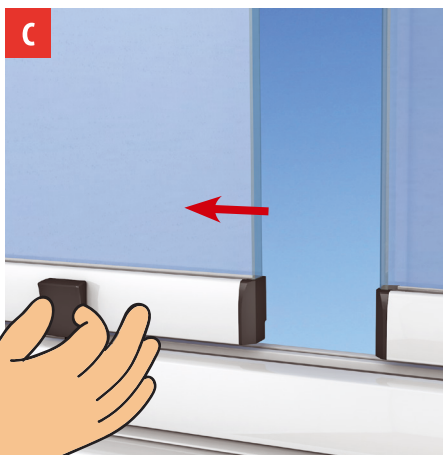
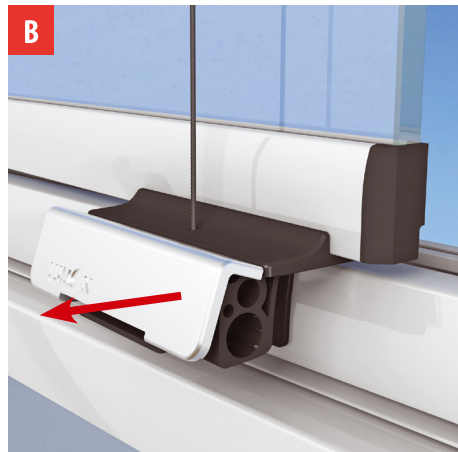

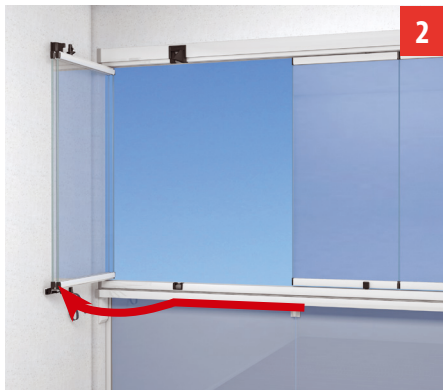

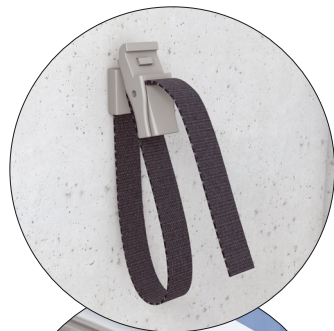
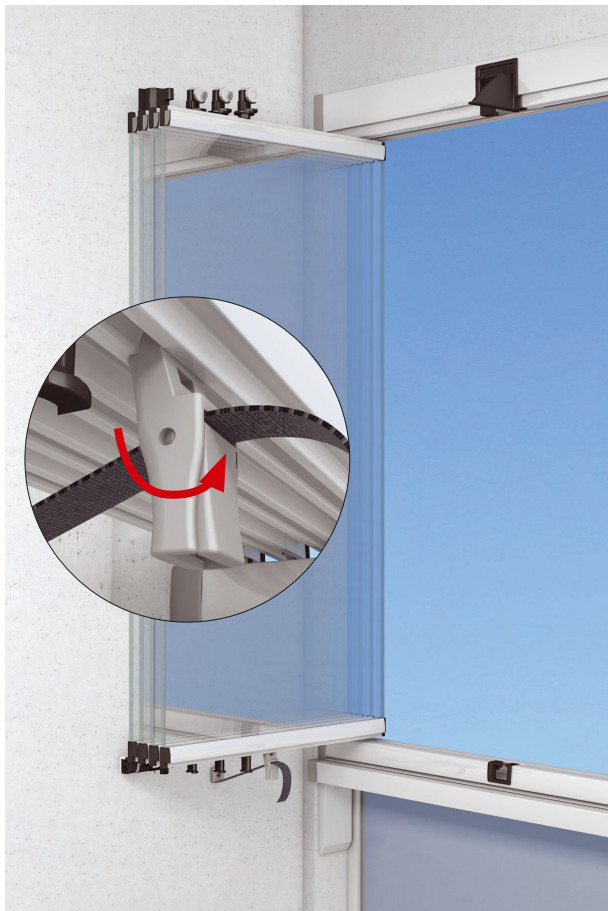

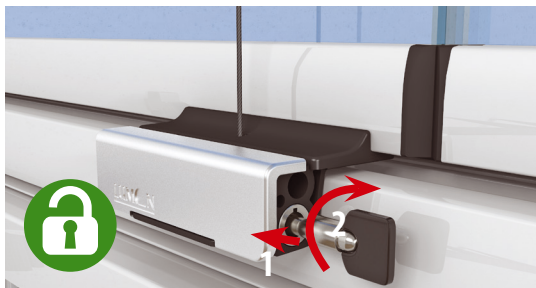





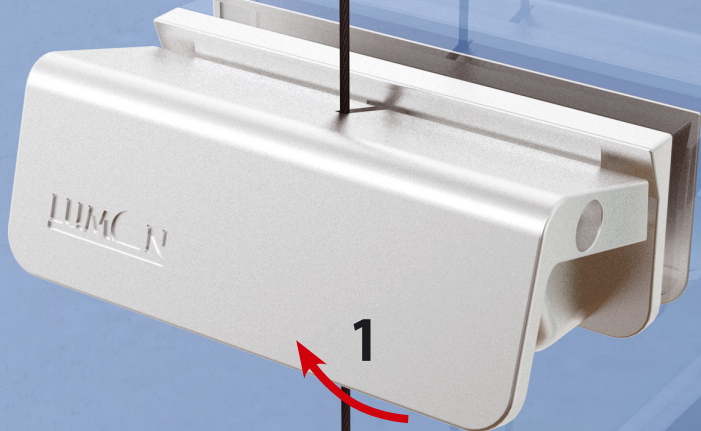

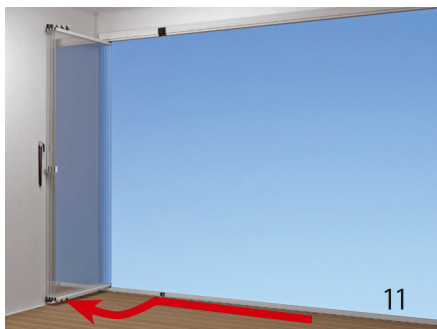
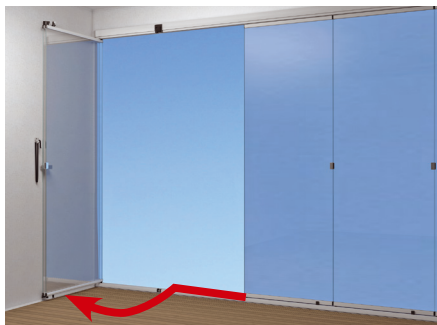
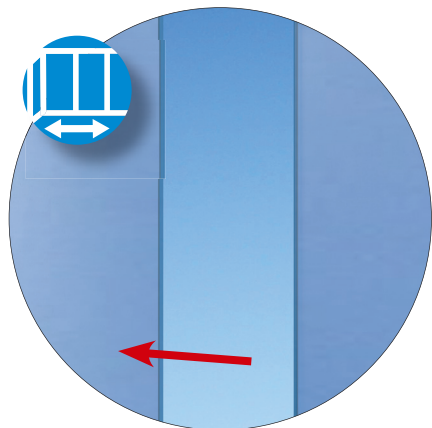

2



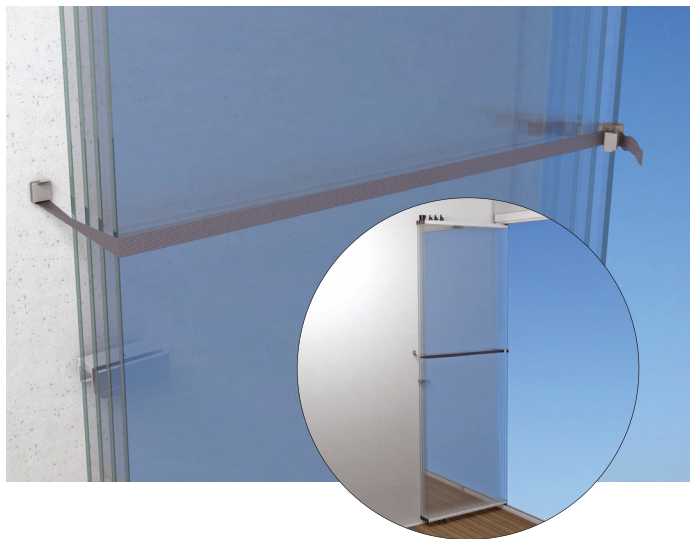
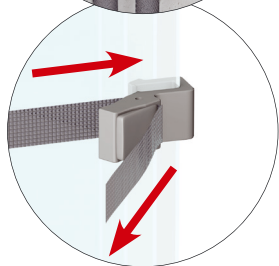
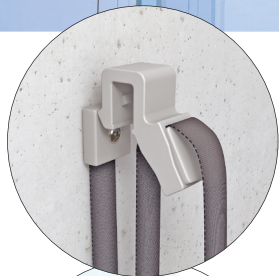

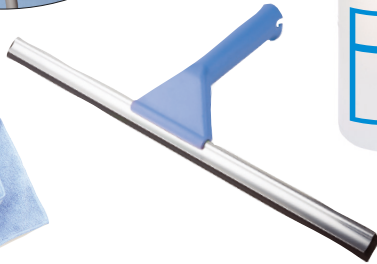

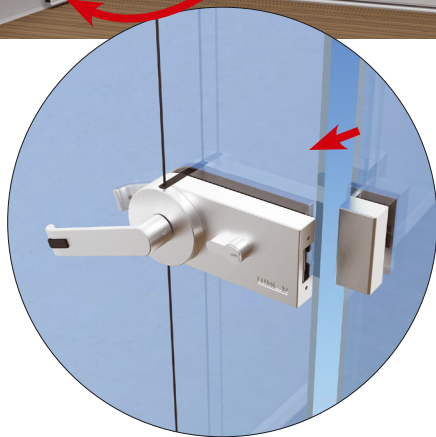
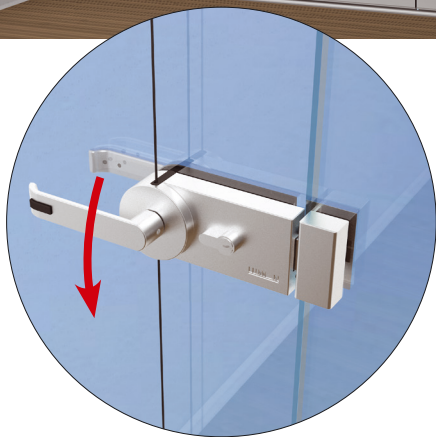



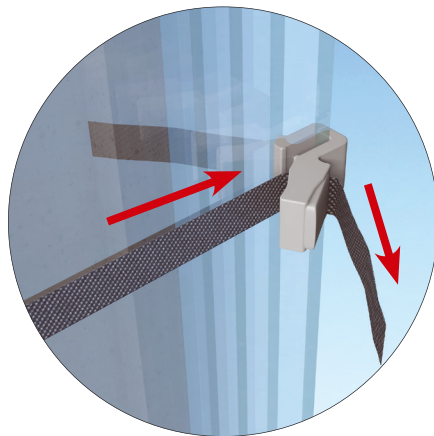

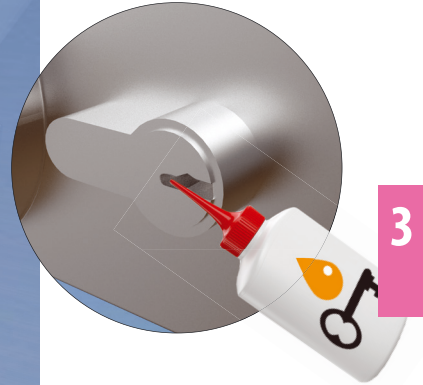

3



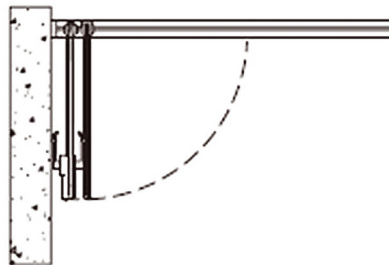
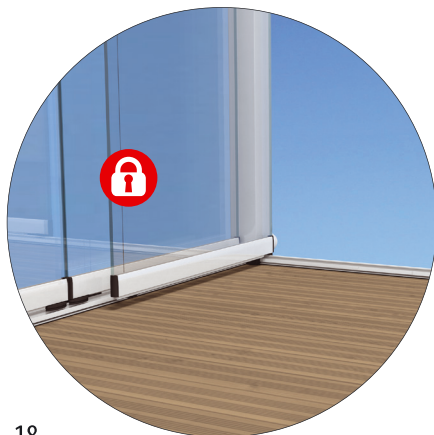
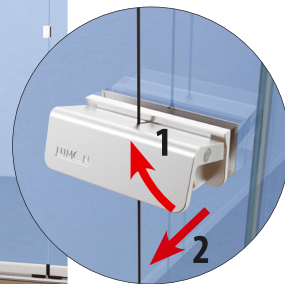



4

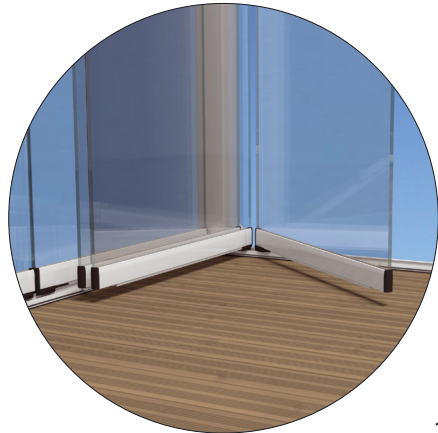
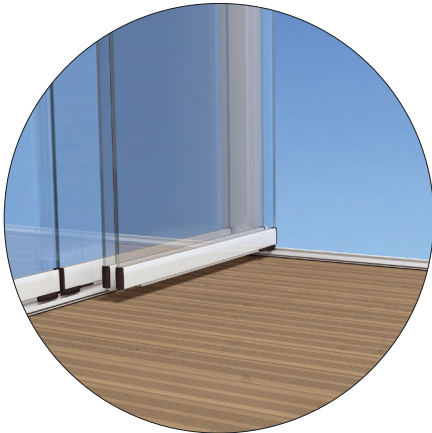

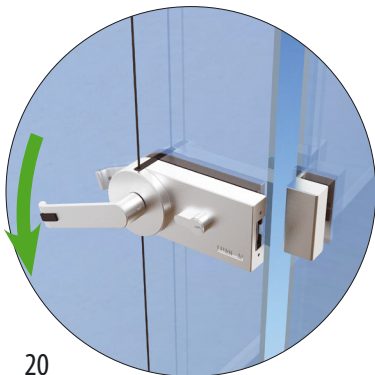
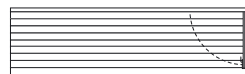

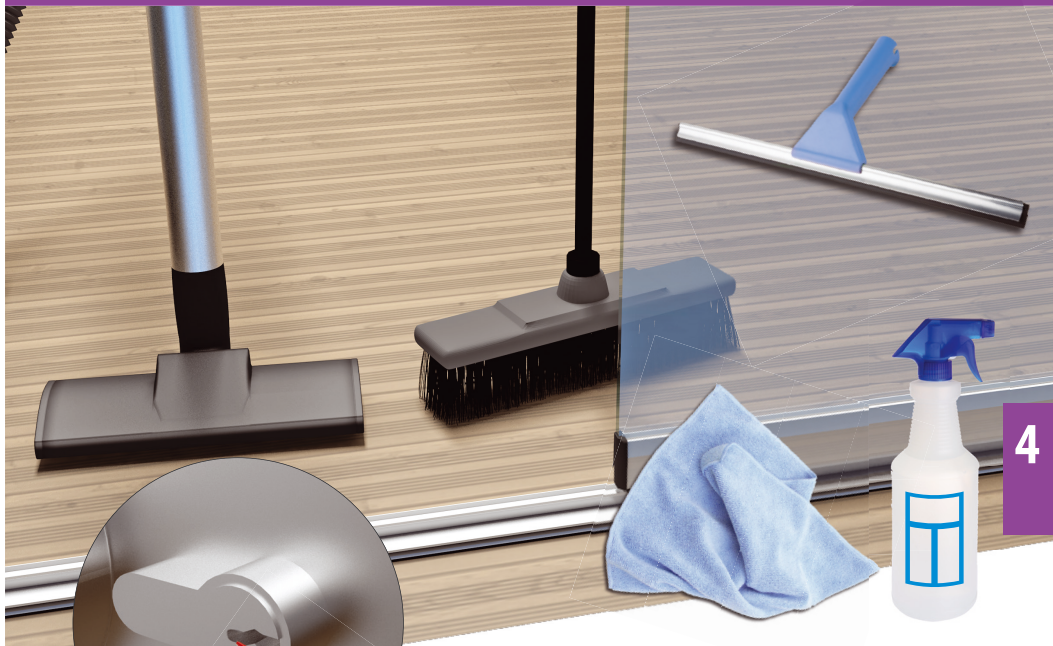

4

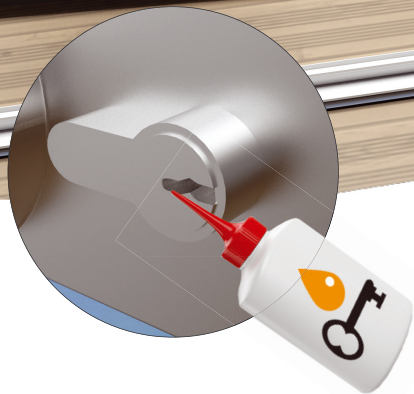

=





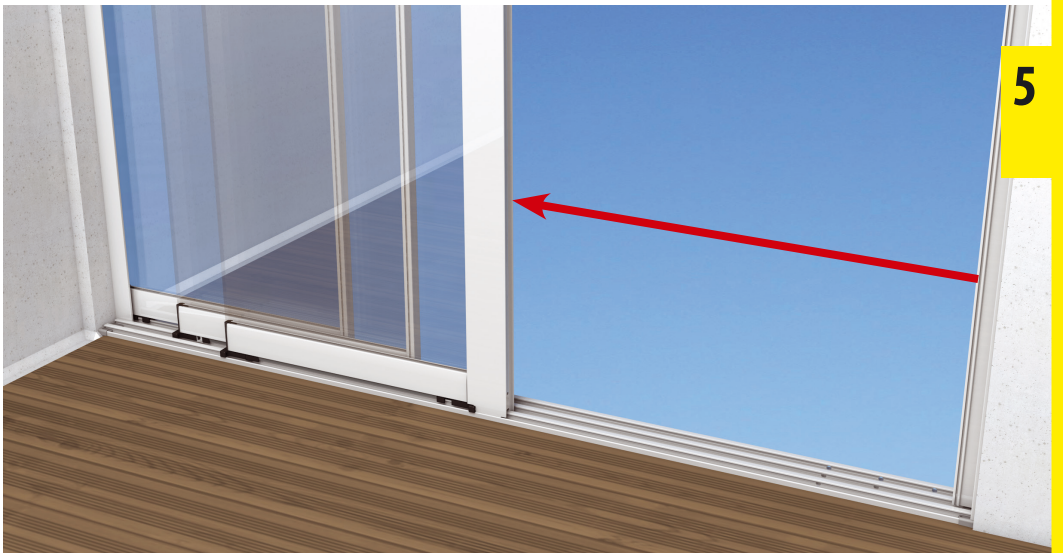
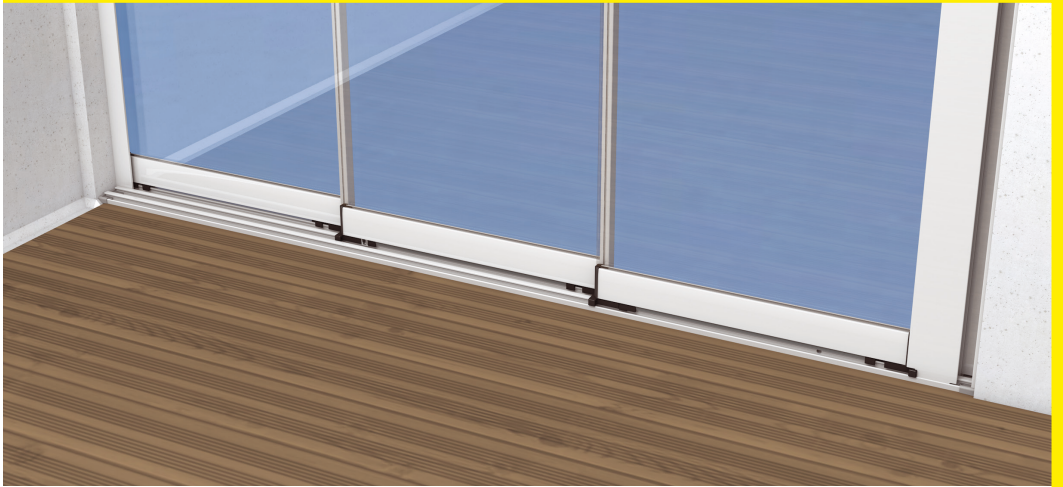

 **ABLOY®**

 **EXTRA**



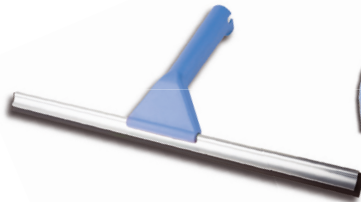

5



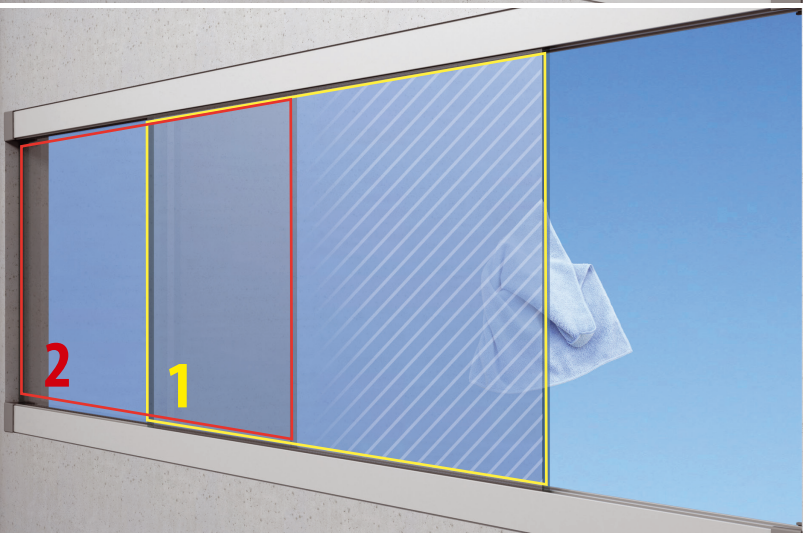
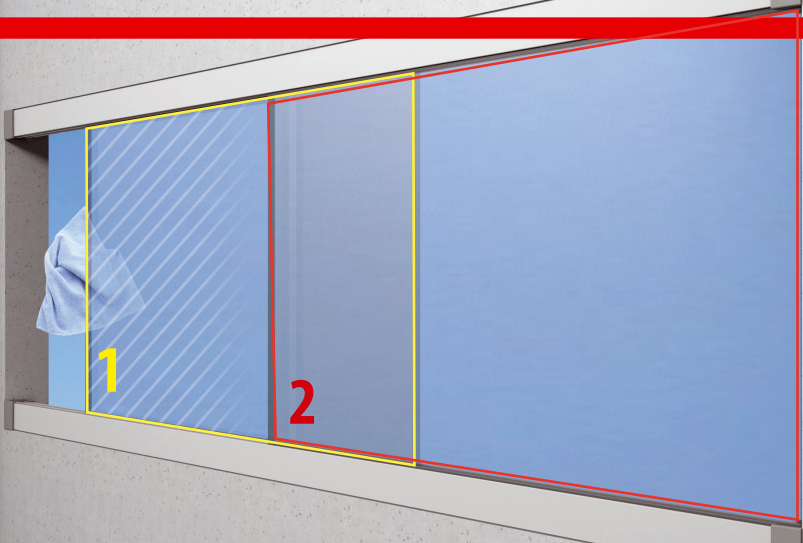

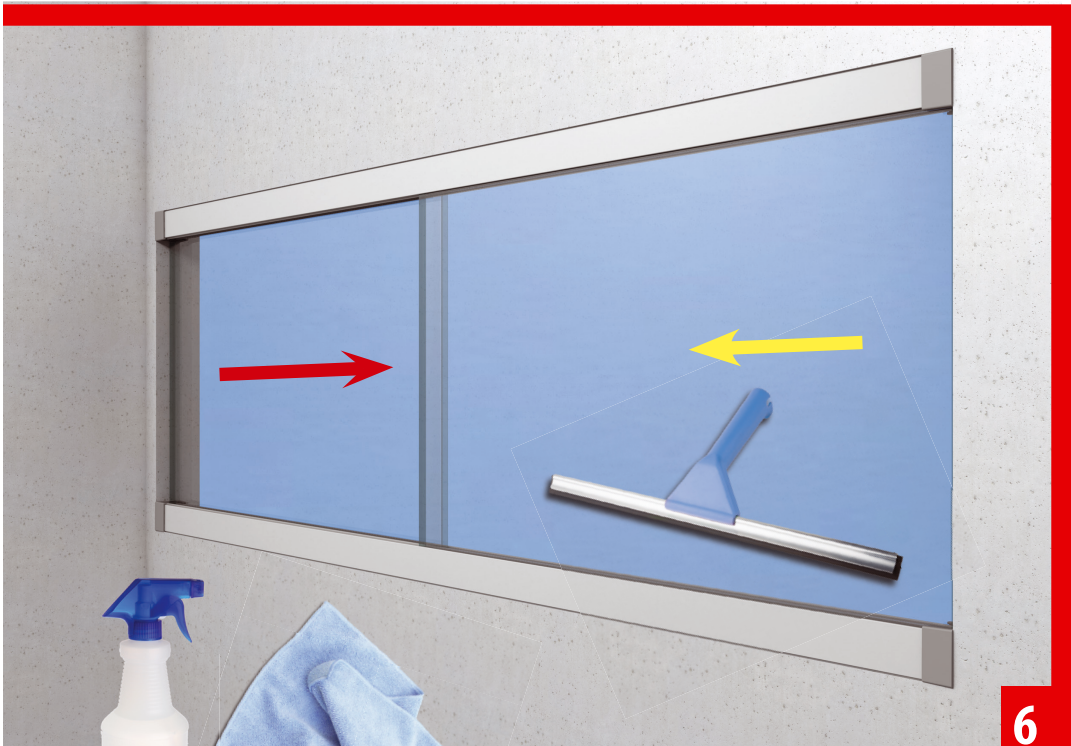

6



LUMON[®]



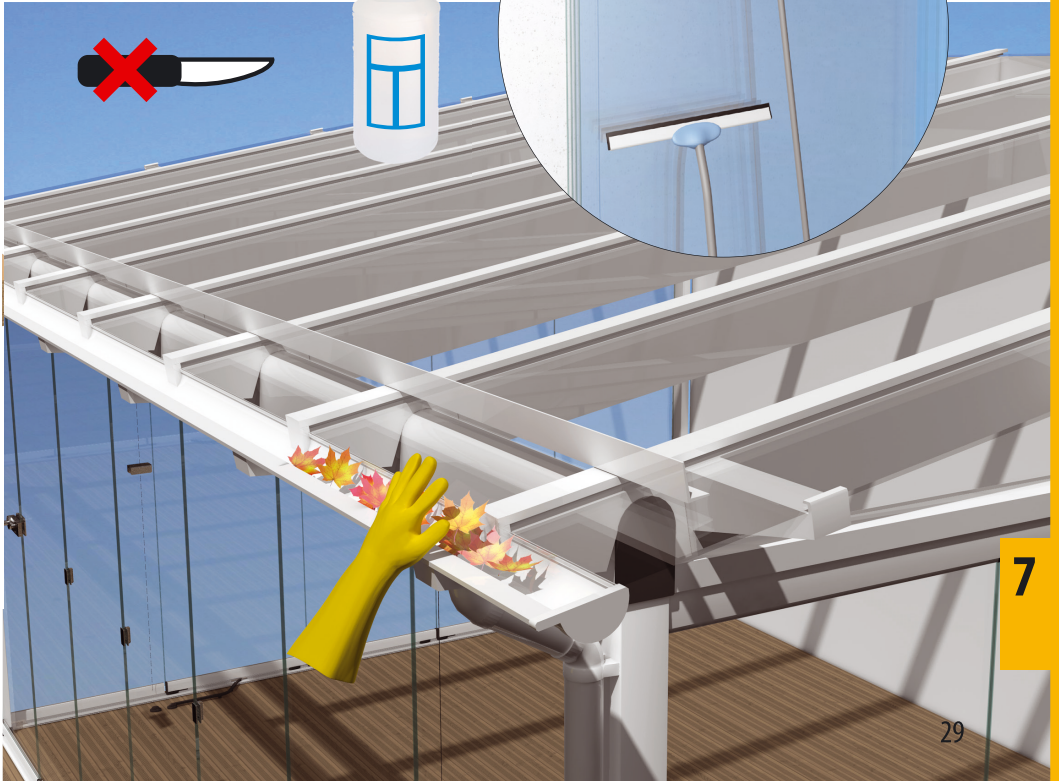
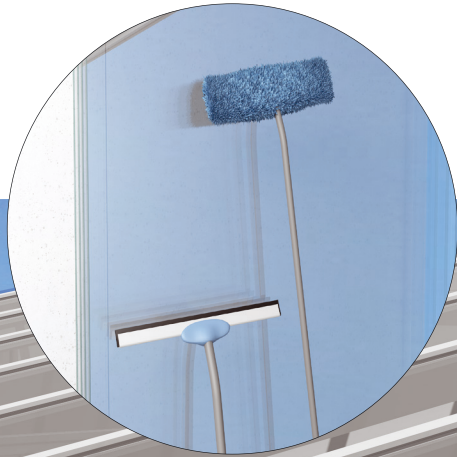

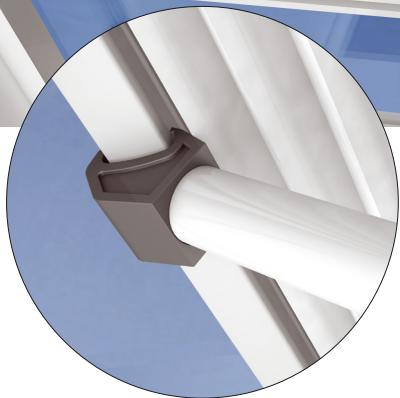
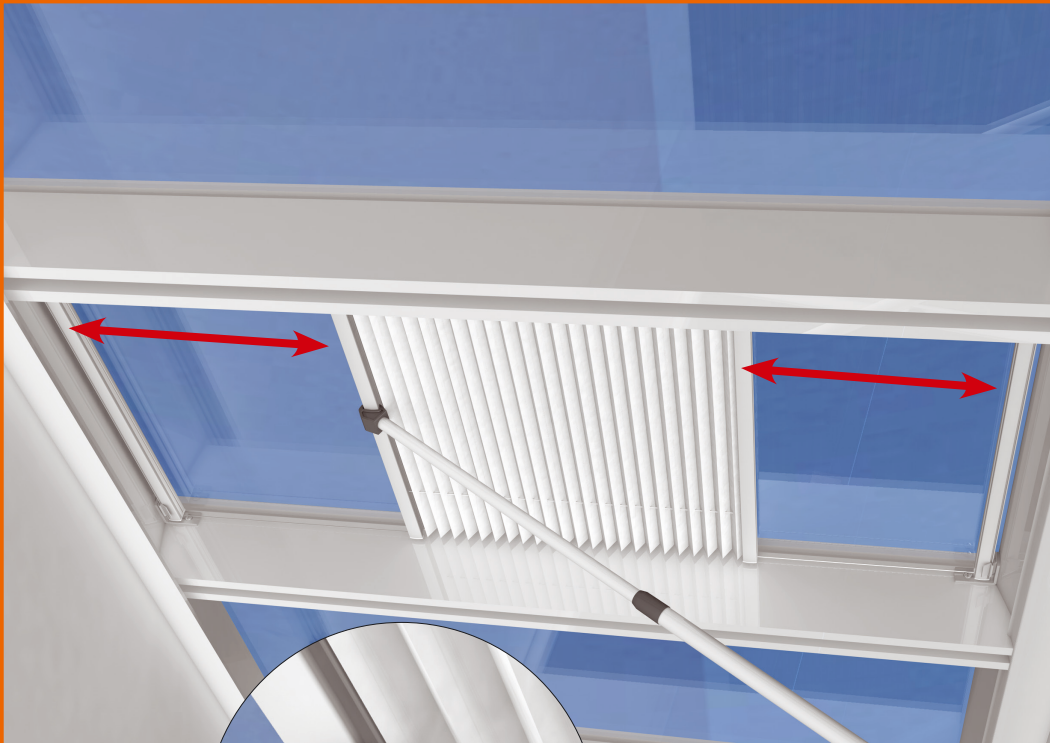

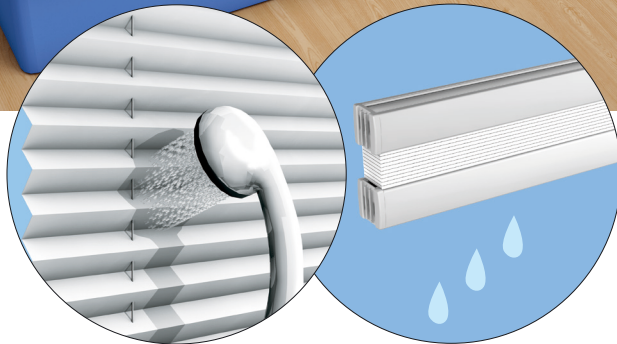
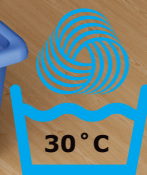
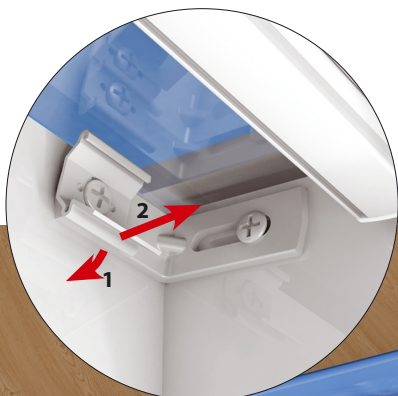

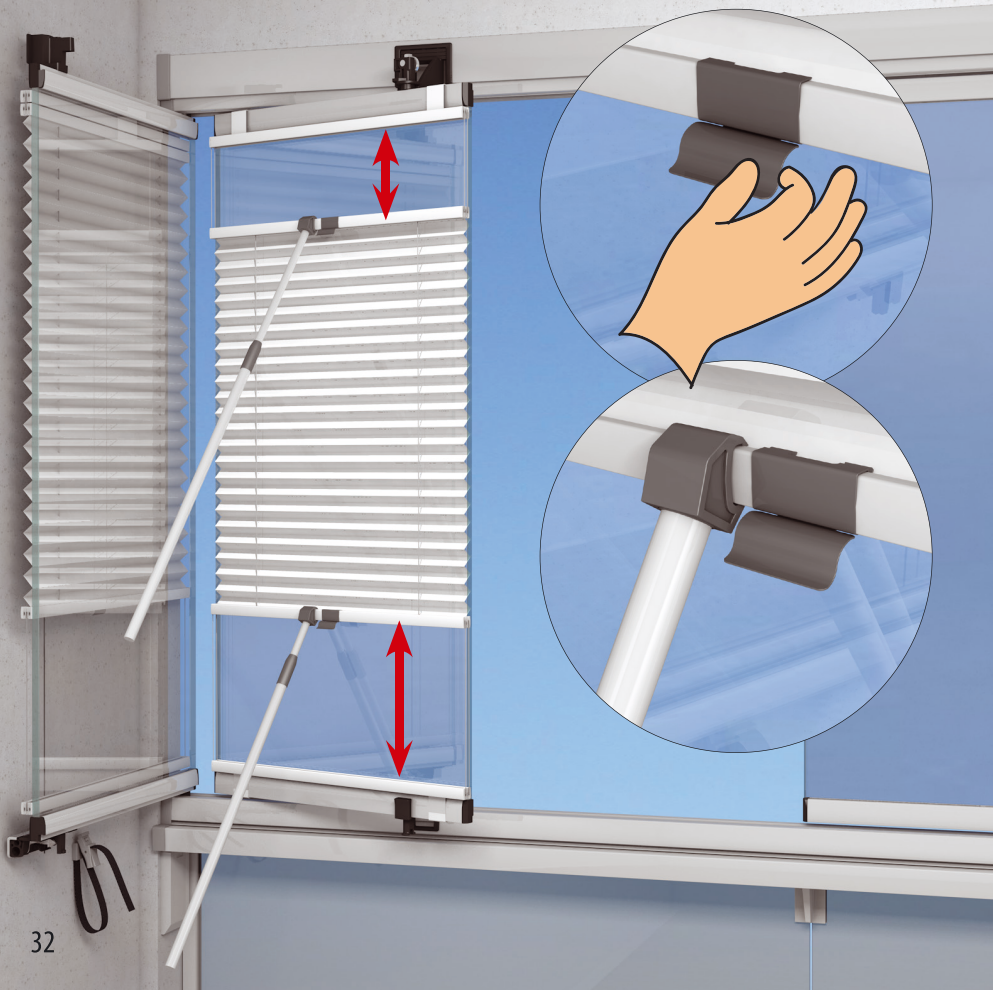

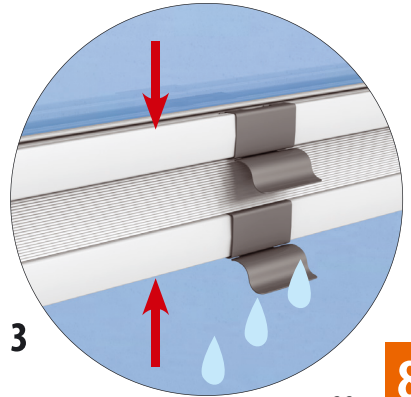
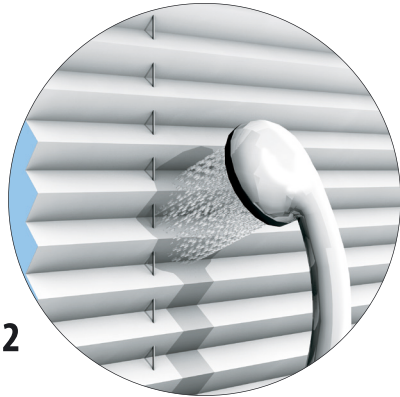

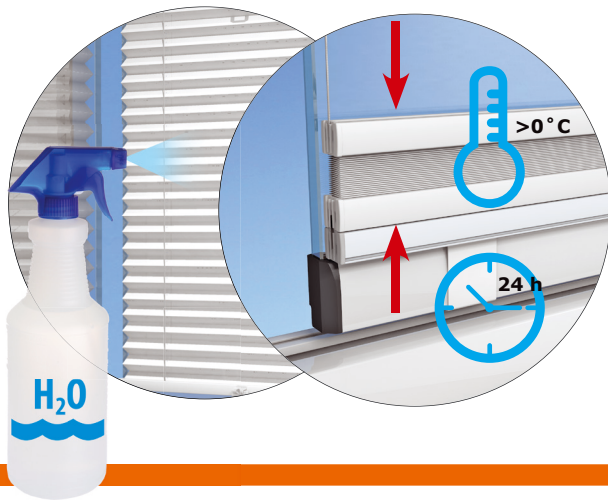
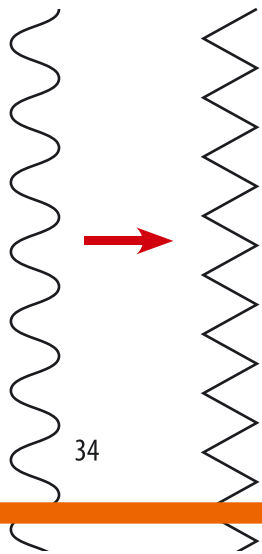
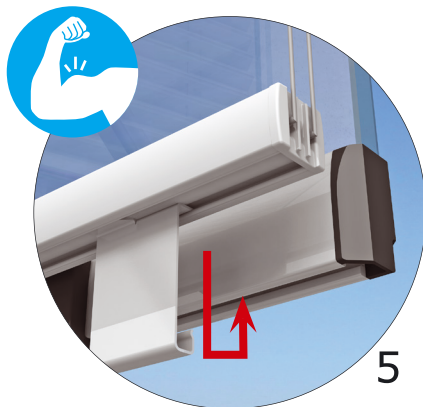
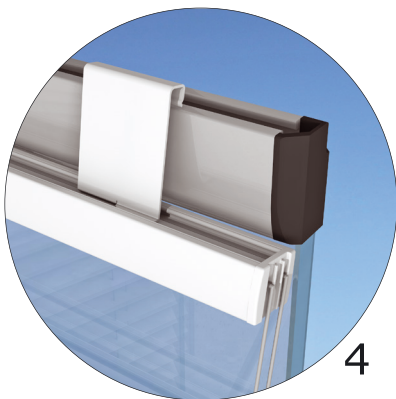

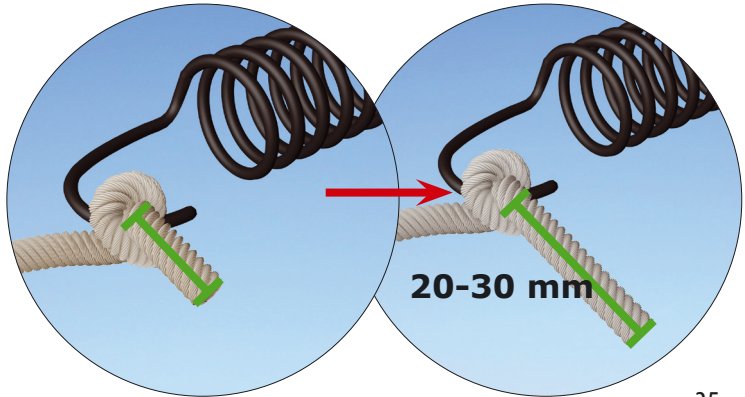
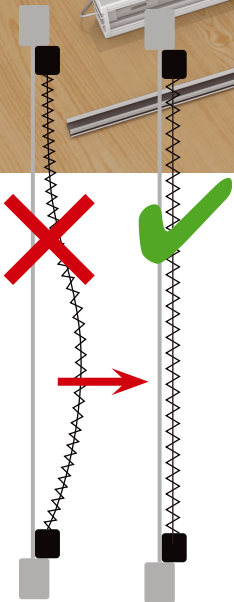

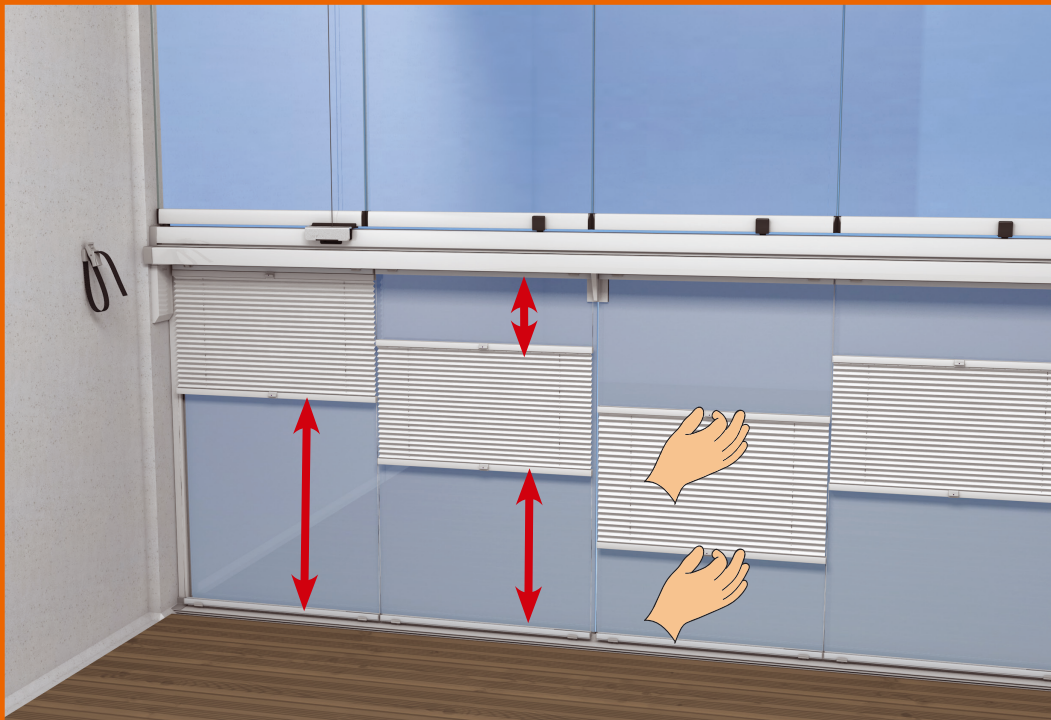

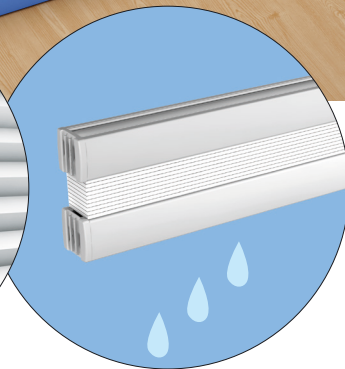
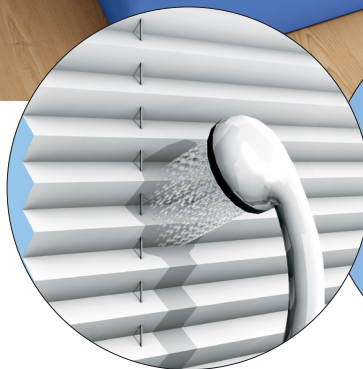
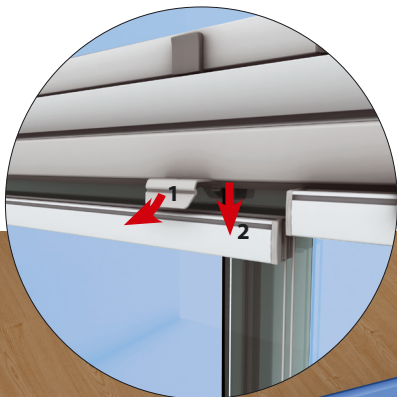



Handwriting practice lines consisting of 12 horizontal lines on a white background.

Valmistaja / Tillverkare / Produsent / Producent / Framleiðandi /
Producer / Fabricante / Producent / Fabricante / Fabriqué par /
Производитель



www.lumon.com

Svenska Lumon AB
Stockholm (huvudkontor)
Sorterargatan 23, 5 tr
Box 124
162 12 Vällingby
Tel. 010-150 21 00
kundservice@lumon.se

Göteborg
Industrivägen 6
433 61 Sävedalen